

APPENDIX H
BUILDING MAPS

LEGISLATIVE BUILDING

FIRST FLOOR

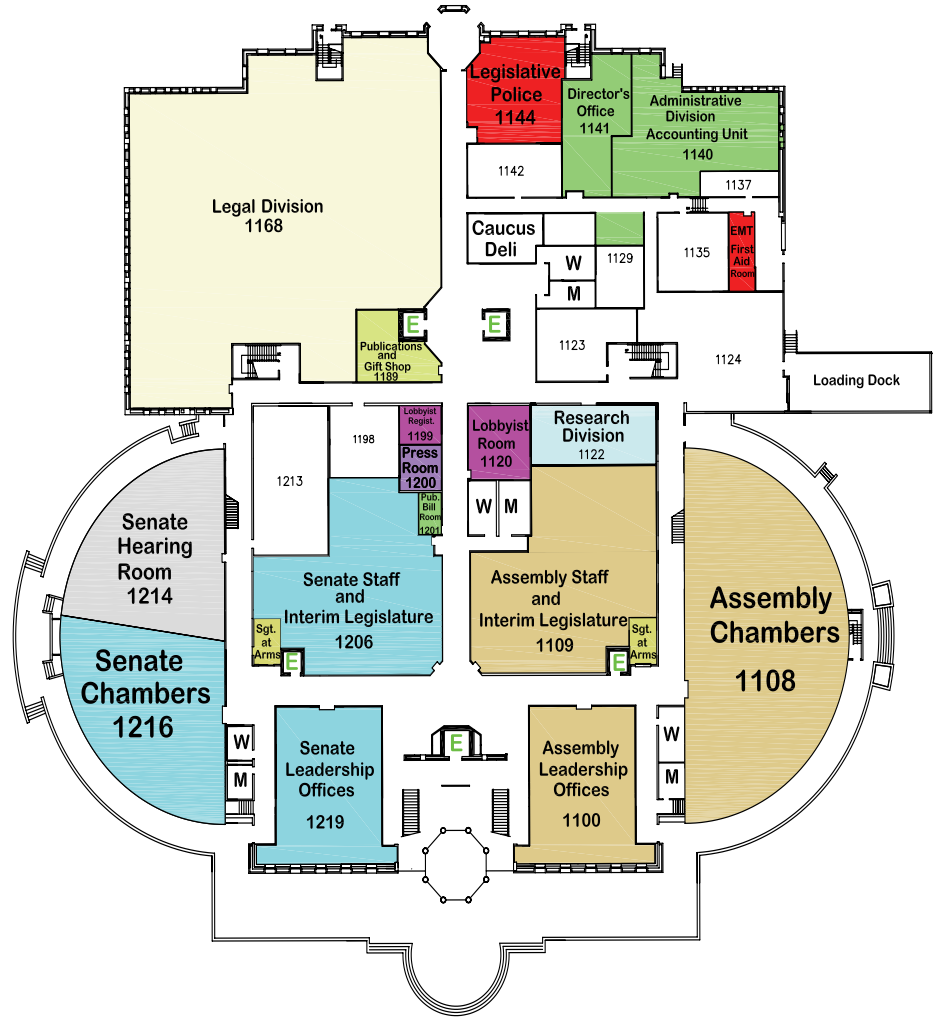

Carson Street - Highway 395

LEGISLATIVE BUILDING

SECOND FLOOR

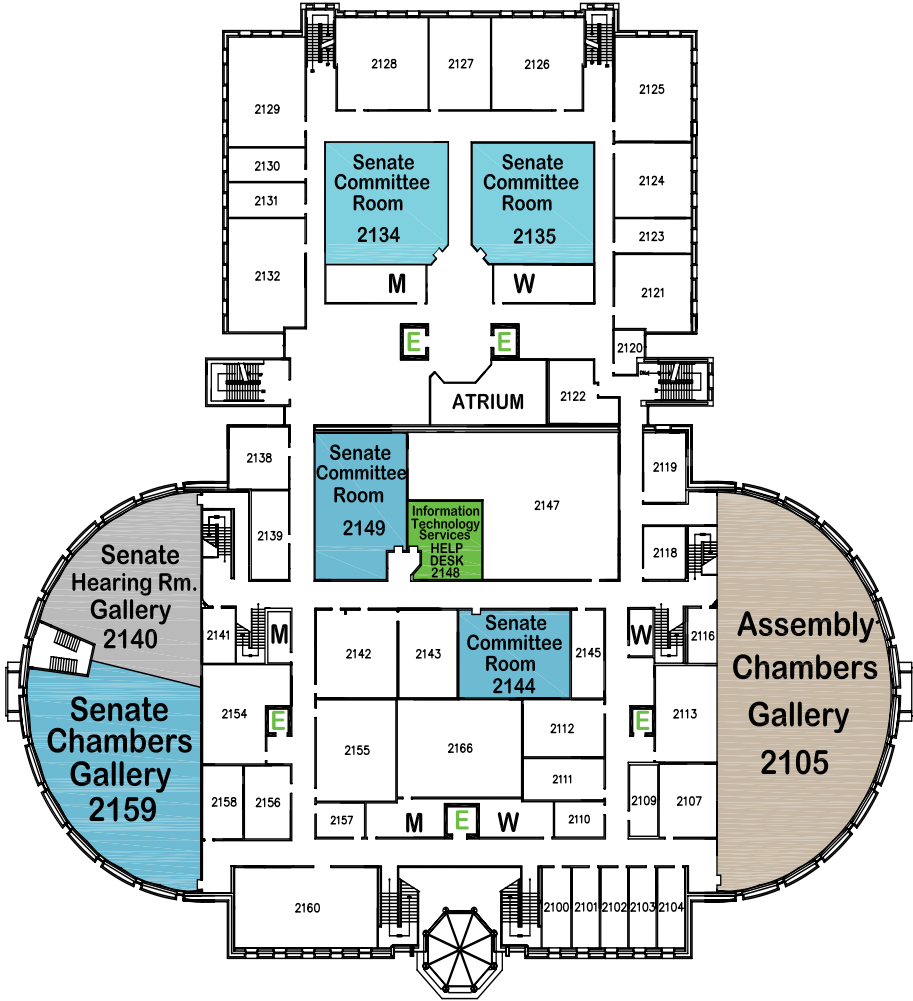

Carson Street - Highway 395

LEGISLATIVE BUILDING

THIRD FLOOR

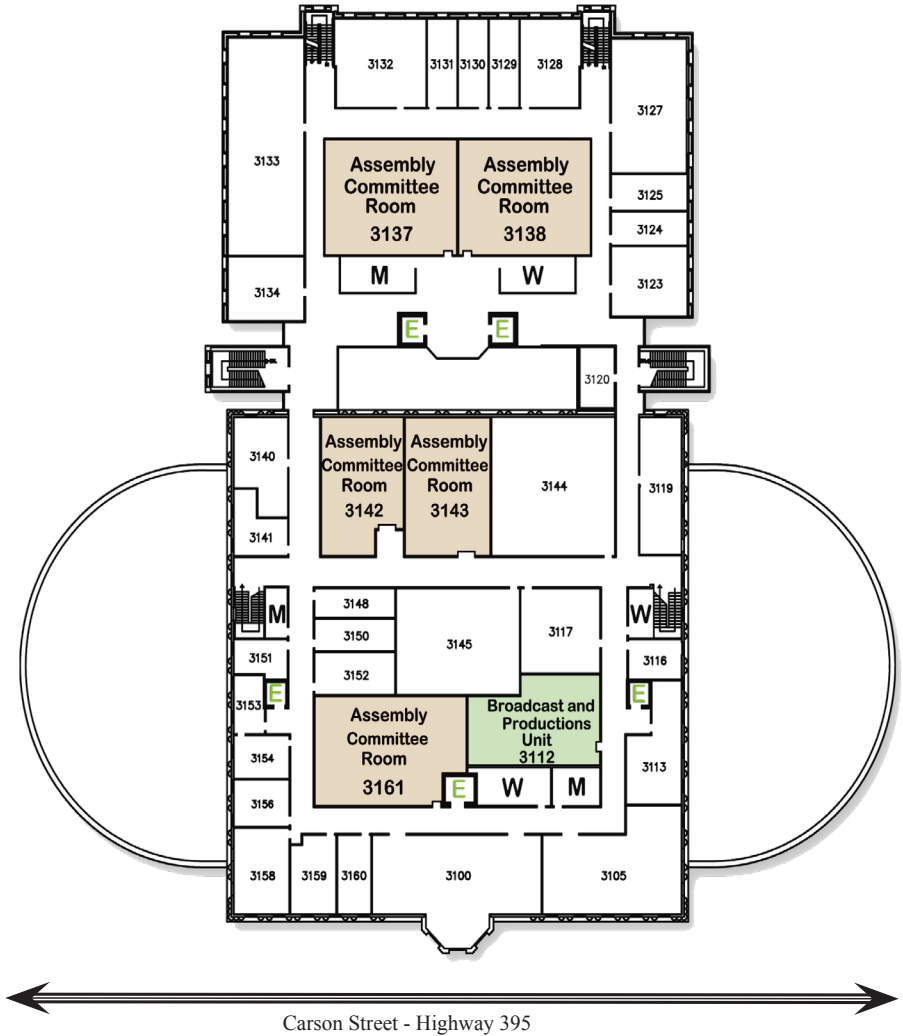

LEGISLATIVE BUILDING

FOURTH FLOOR

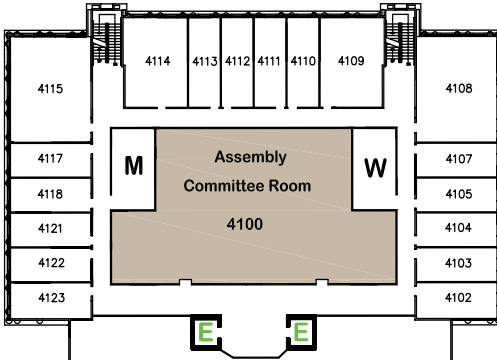

FOURTH FLOOR

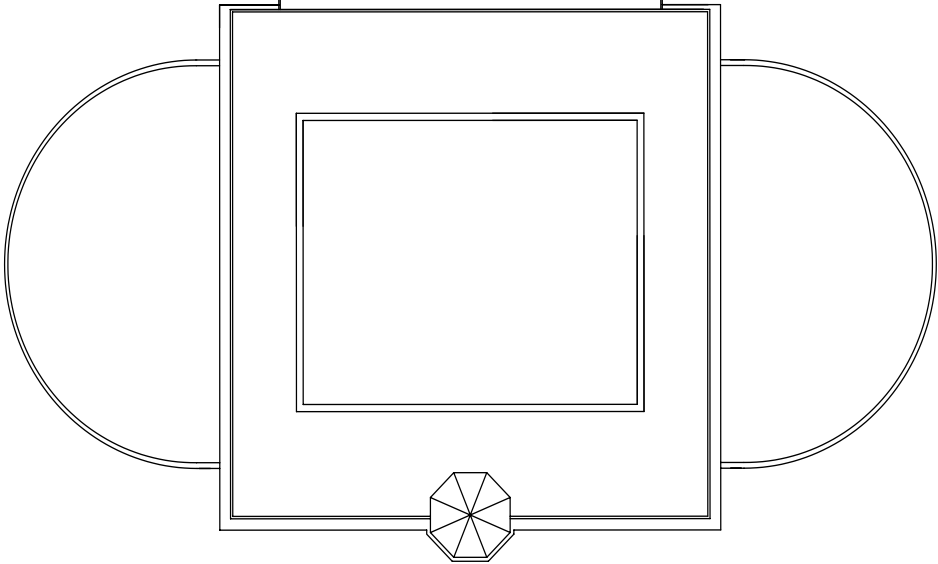

Carson Street - Highway 395

GRANT SAWYER STATE OFFICE BUILDING
NEVADA LEGISLATURE—FOURTH FLOOR

